

FALCO

FRTV150

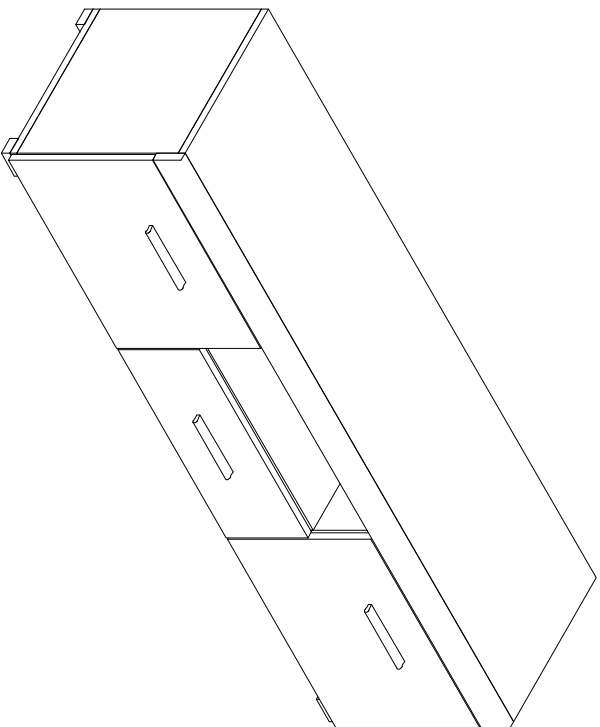

25.6.2017

- (D)** Montageanleitung
- (FR)** Notice de montage
- (NL)** Handleiding voor de montage
- (CZ)** Montážní návod
- (HU)** Szerelési útmutató
- (TR)** Montaj talimatı

- (GB)** Assembly Instructions
- (IT)** Istruzioni di montaggio
- (PL)** Instrukcja montażu
- (SK)** Návod na montáž
- (RO)** Instrucțiunile de montaj
- (RU)** Инструкции по монтажу

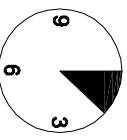
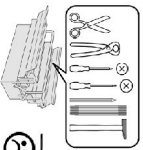

20 min.

1

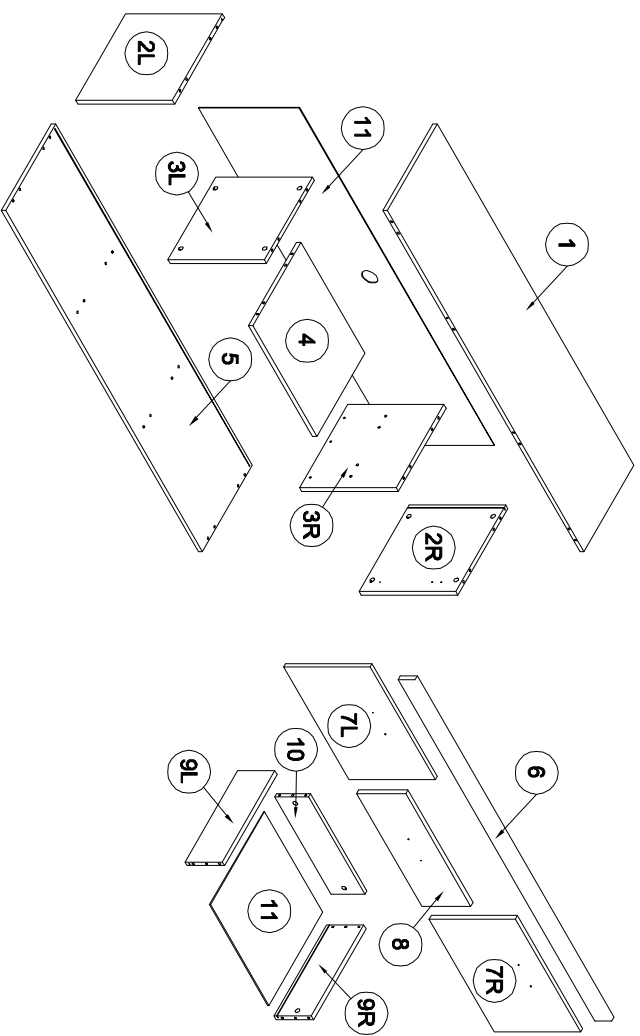

NA 4x13 4x13	PC x4 8x32	ND 3.5x16 3.5x16	YA 4x27 4x27	W x3 3.5x13	Y x6 x6	N 3x20 3x20	X x8 6.3x13
B x28 x28	A x32 8x32	C x28 x28	Z x28 x28	NB x6 3.5x13	RPS x1 x1	RC x4 x4	H x8 6.3x13

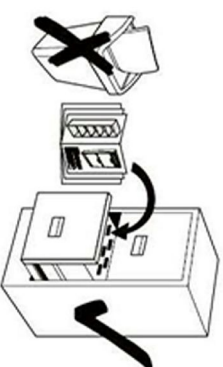
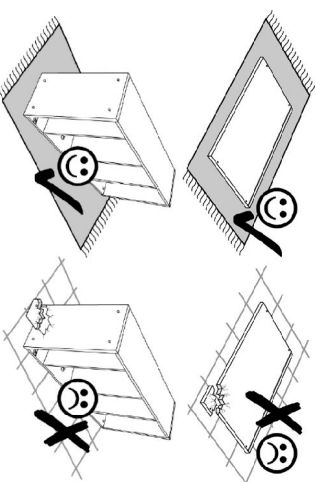

2

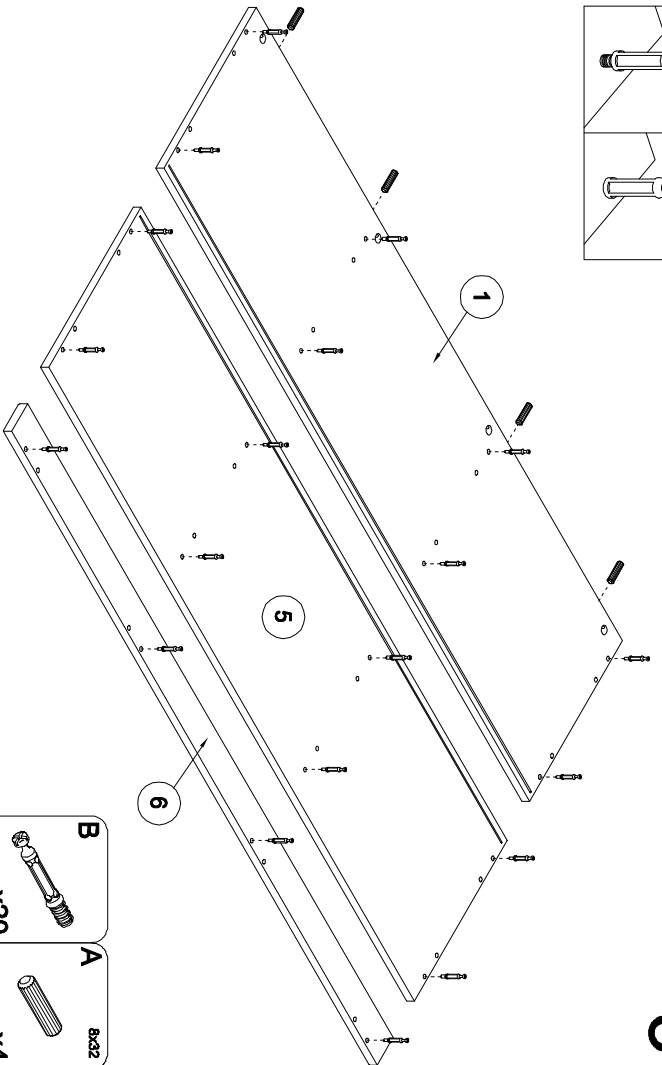
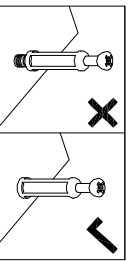

3

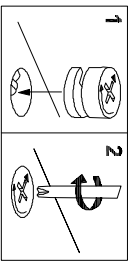
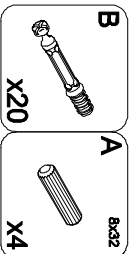

4

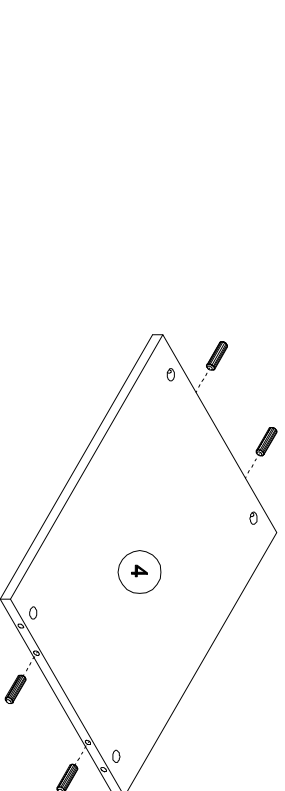
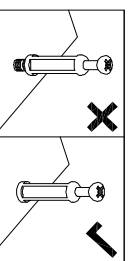

5

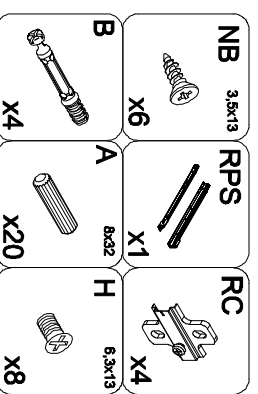
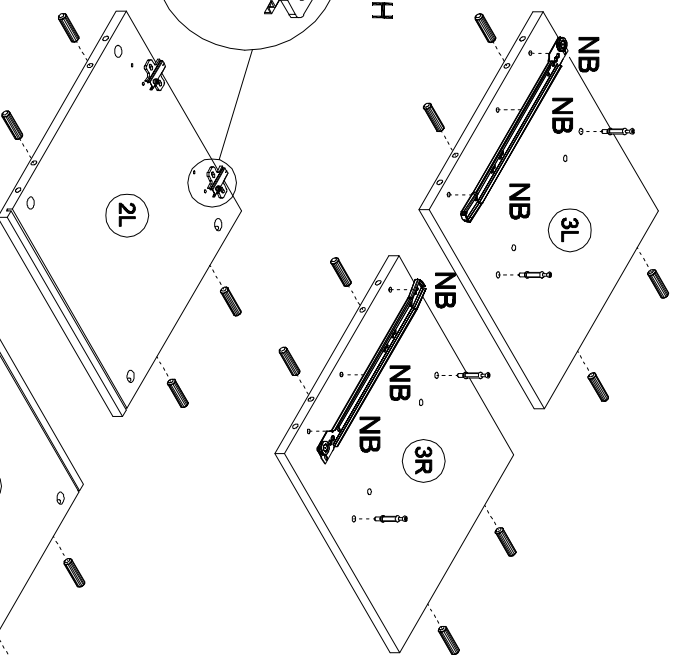
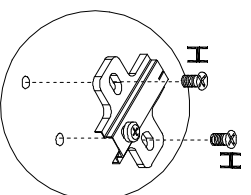

6

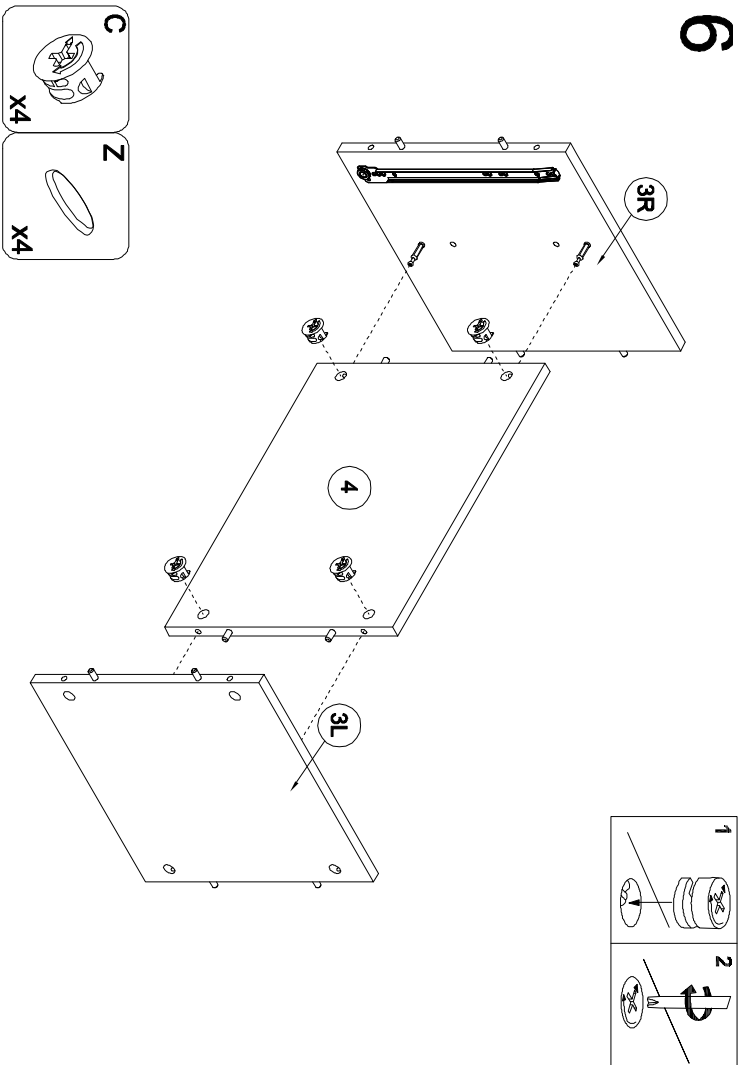

8

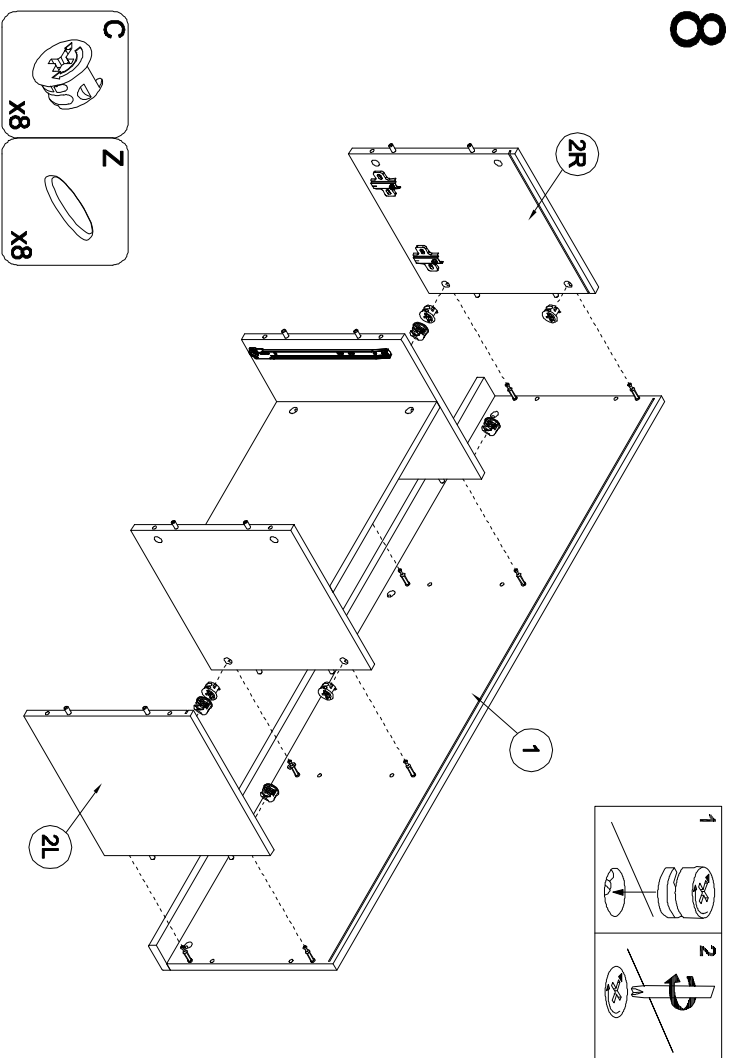

7

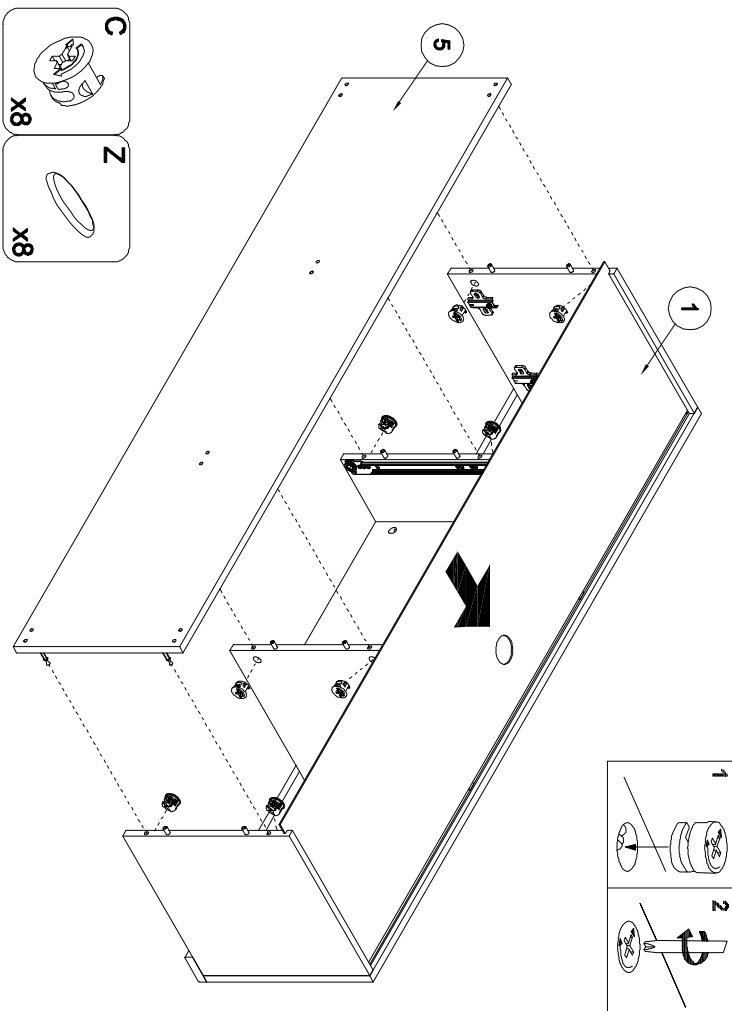

9

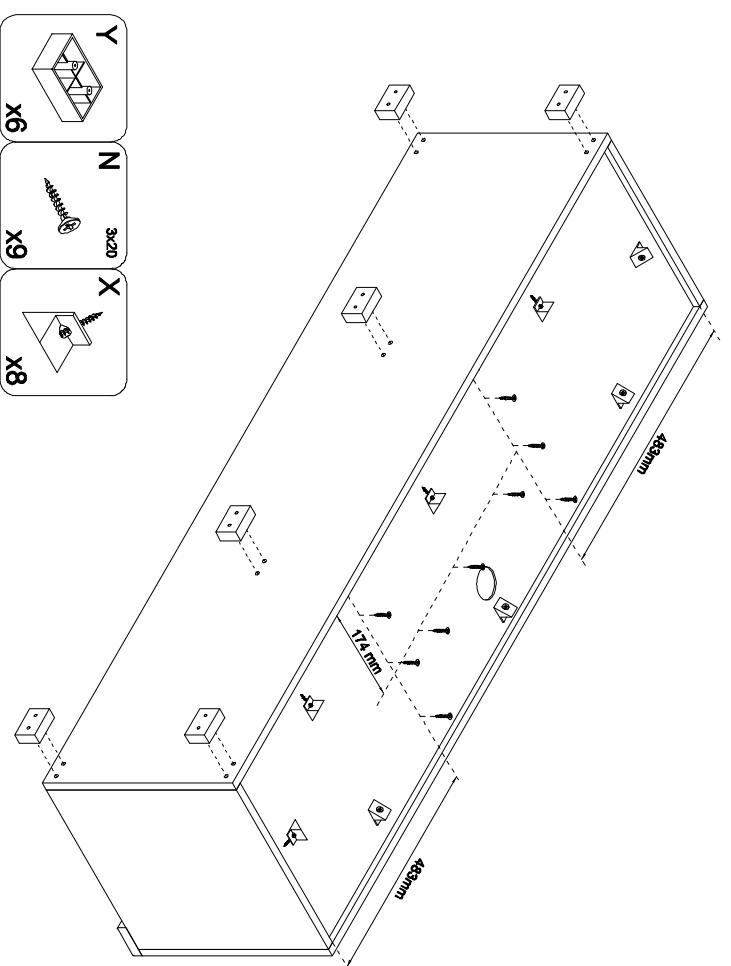

10

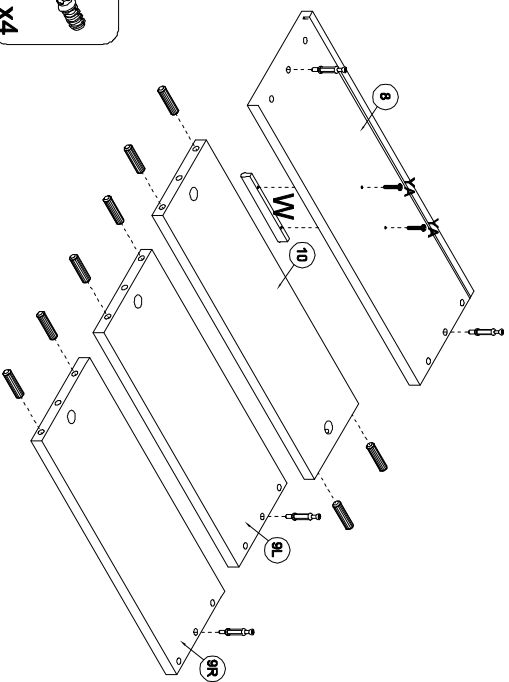

- | | |
|-------------------------|----------------|
| A
8x32
X8 | B
X4 |
| YA
4x27
X2 | W
X1 |

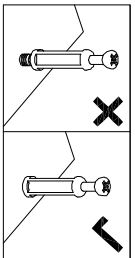

- | | |
|----------------|----------------|
| C
X2 | Z
X2 |
|----------------|----------------|

11

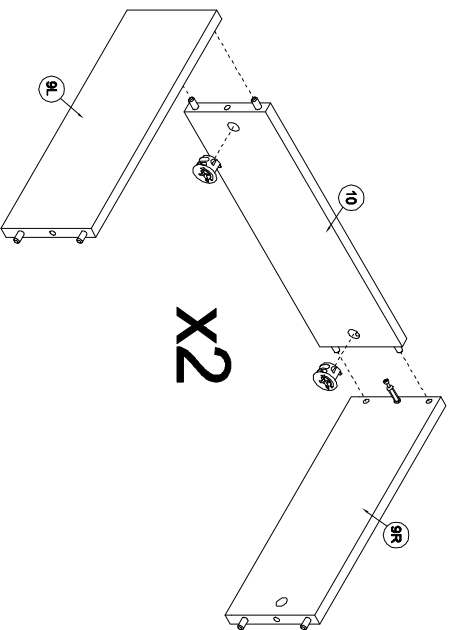

X2

12

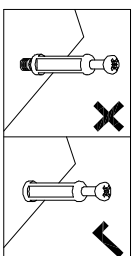
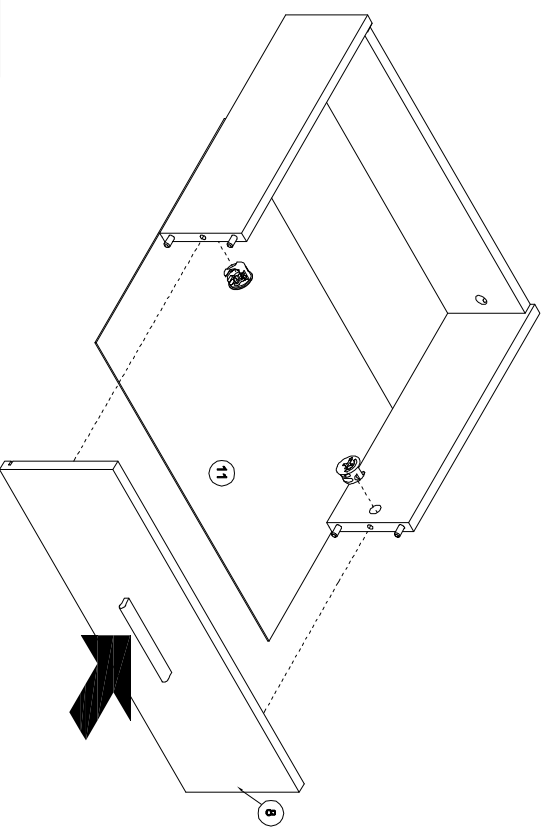

- | | |
|----------------|----------------|
| C
X2 | Z
X2 |
|----------------|----------------|

13

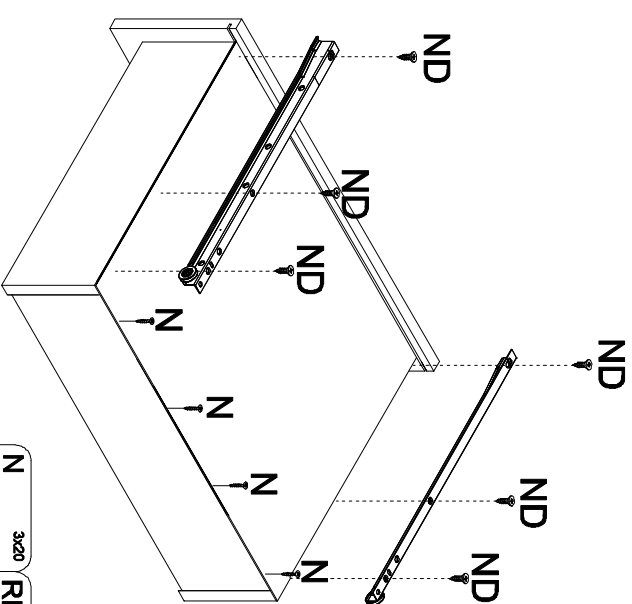

- | | | |
|------------------------|------------------|---------------------------|
| N
3x20
X4 | RPS
X1 | ND
3.5x16
X6 |
|------------------------|------------------|---------------------------|

PC 4x4	YA 4x27 X4	NA 4x13 X8	W X2
-----------	------------------	------------------	---------

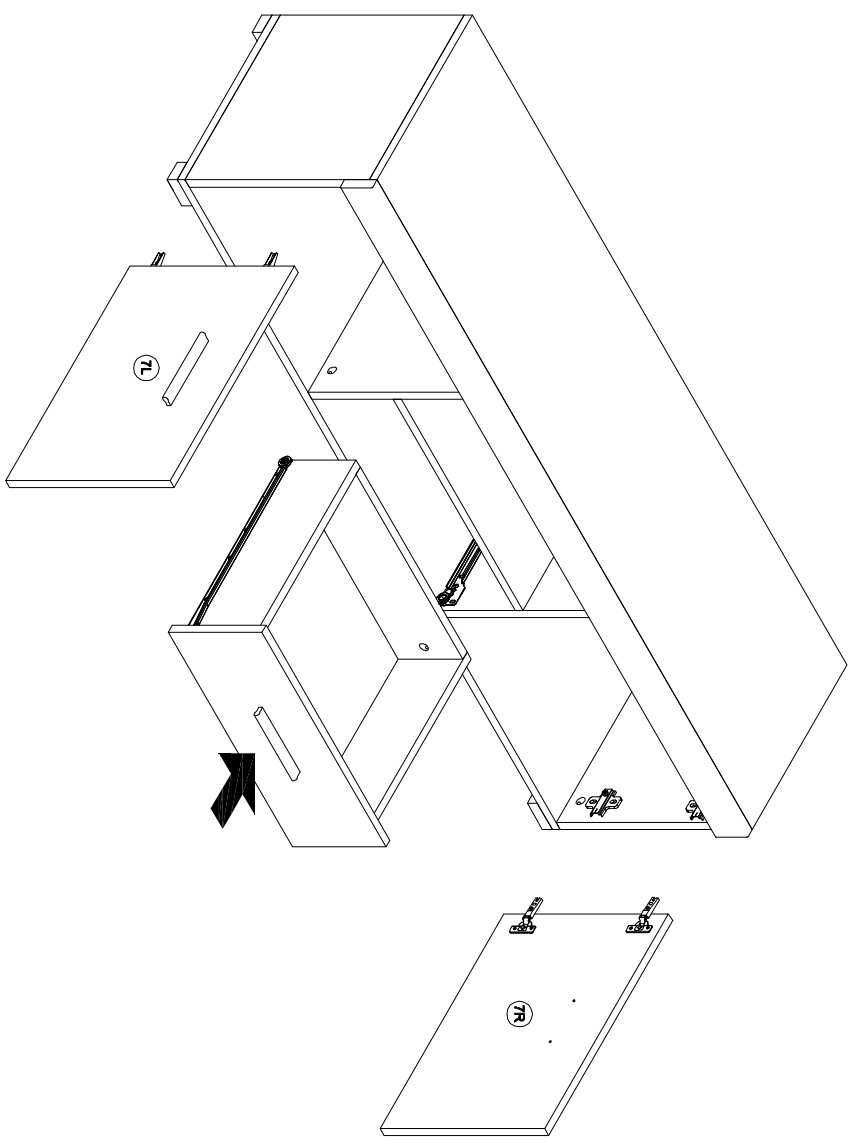
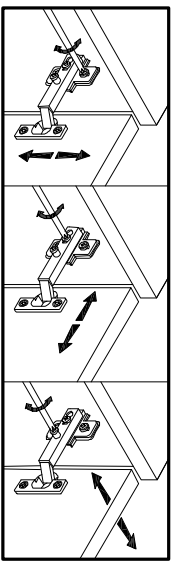
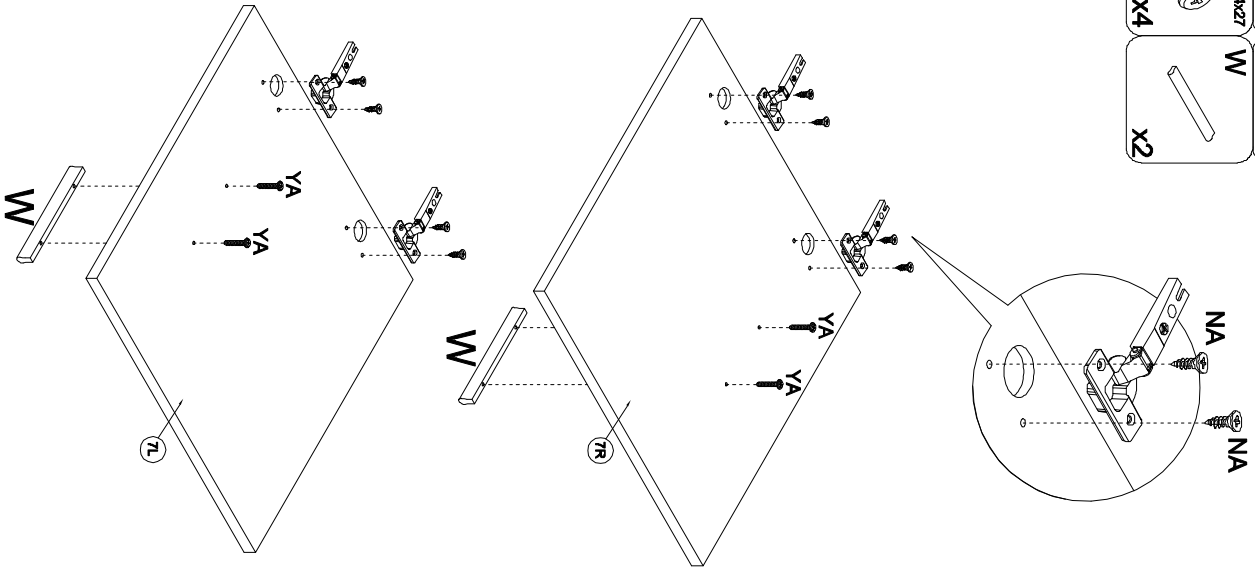

FALCO

P100

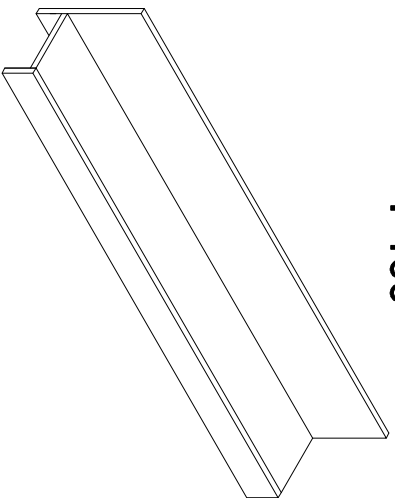

25.5.2017

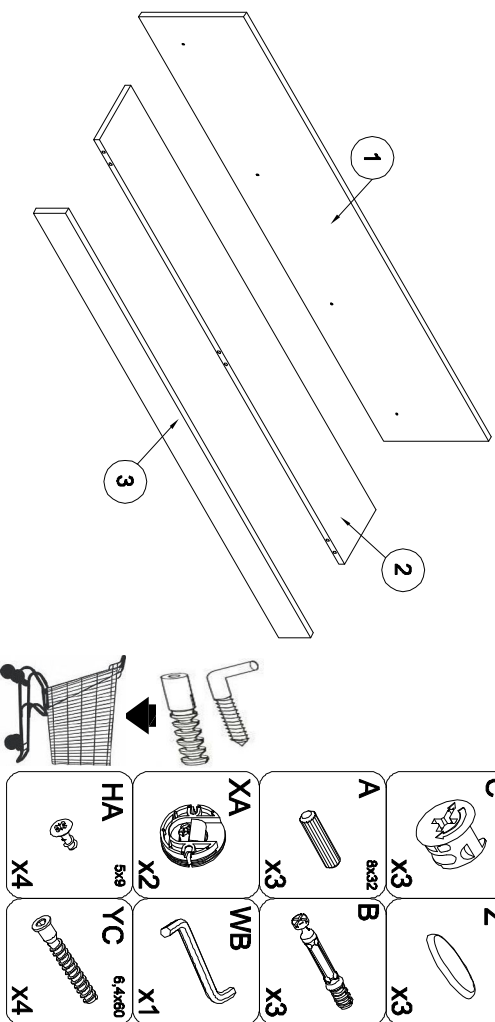

C X3	A 8x32 X3	XA X2	HA 5x8 X4
Z X3	B X3	WB X1	YC 6.4x60 X4

- D** Montageanleitung
- FR** Notice de montage
- NL** Handleiding voor de montage
- CZ** Montážní návod
- HU** Szerelési útmutató
- TR** Montaj talimatı
- GB** Assembly Instructions
- IT** Istruzioni di montaggio
- PL** Instrukcja montażu
- SK** Návod na montáž
- RO** Instrucțiunile de montaj
- RU** Инструкции по монтажу

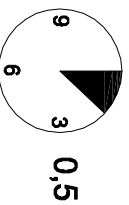
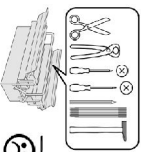

1

2

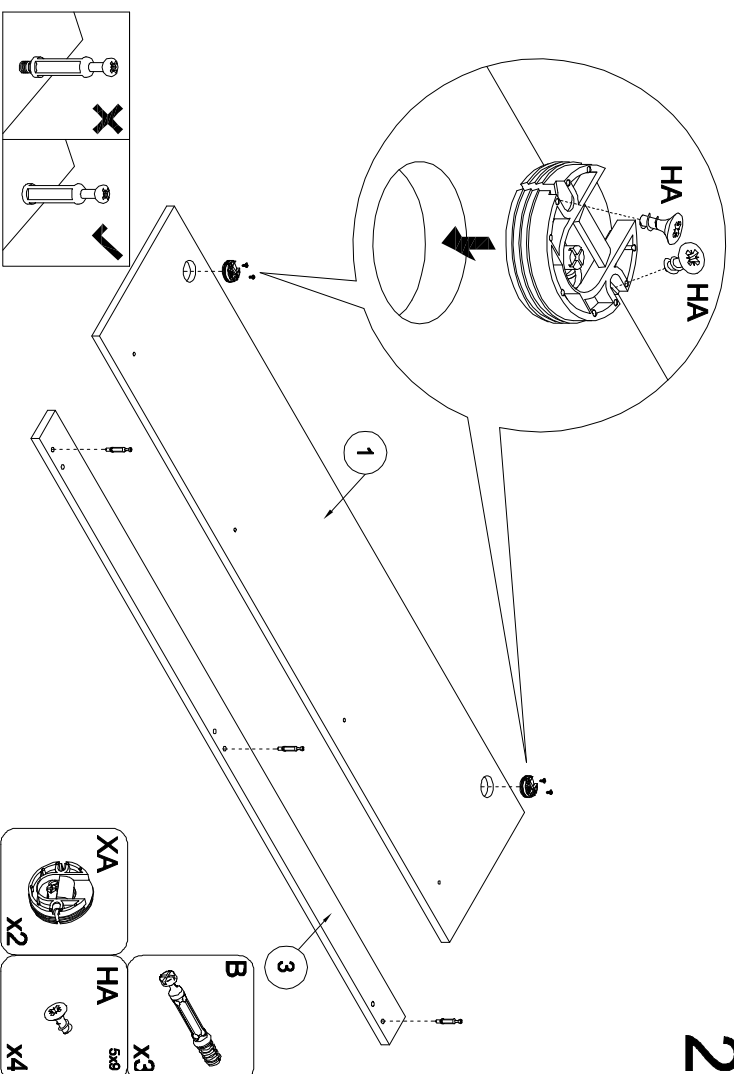

A 8x32 X3

3

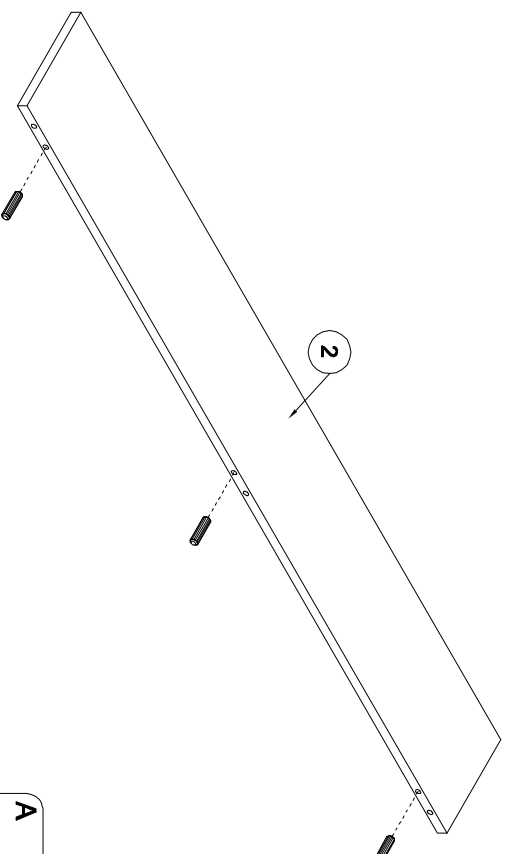

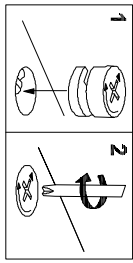

4

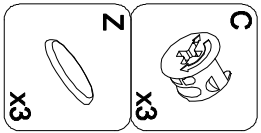
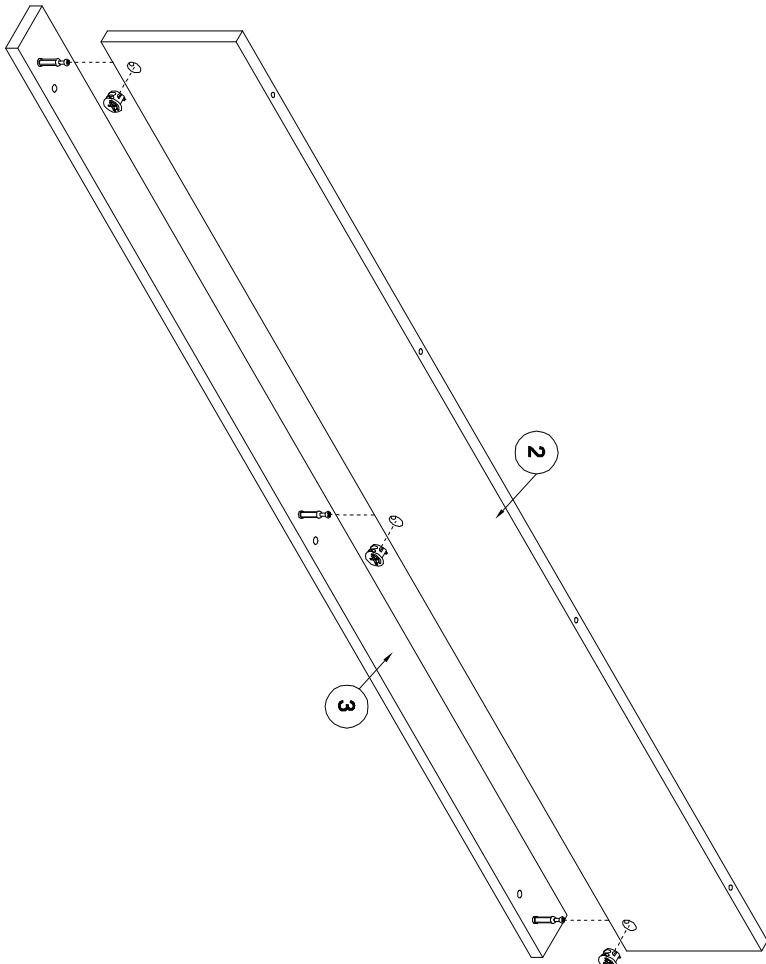

5

